

Installation Procedure

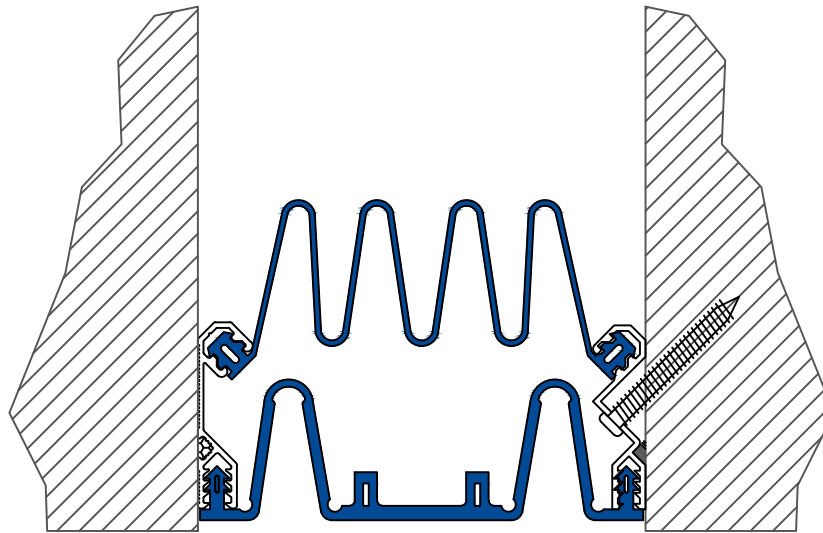

Wabo® WeatherSeam Model(s) "WSC 200-600" Horizontal & Vertical Expansion Control Systems

The following installation procedure is very important and must be fully understood prior to beginning any work. To ensure proper installation and performance of expansion joint system the following actions must be completed by the installing contractor. **Failure to do so will affect product warranty.**

- 1) Carefully read and understand installation procedure. Contact Emseal's Technical Service Department at (508) 836-0280 for product assistance.
- 2) Inspect all shipments and materials for missing or damaged components and hardware. Contact Customer Service at (508) 836-0280 with Emseal's order number and invoice for prompt assistance.
- 3) Inspect substrate or adjacent construction for acceptance before beginning work. Report unacceptable construction to the project manager for scheduled repair work.
- 4) Review Emseal shop drawings for project specific detailed information if Engineering services were purchased at time of order.

Standard Components

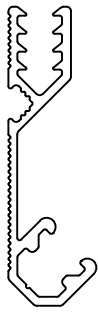

Epoxy Wall Mount Aluminum Extrusion
(P/N - 12201)

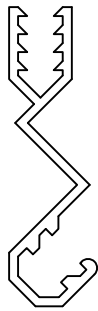

Wall Mount Aluminum Extrusion
(P/N - 1292)



1/4" x 2 1/2" Screw Anchor
(P/N - 5782)

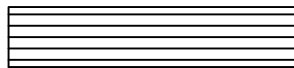

Plastic Insert
(P/N - 5786)

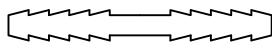

Butt splice clip
(P/N - 1192)

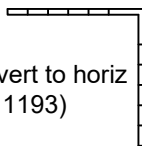

Splice clip: vert to horiz
(P/N - 1193)

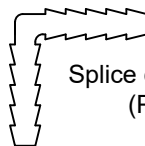

Splice clip: same plane
(P/N - 1194)

* Splice Clips



* PP Primer
(P/N - 2717)



* 241F Adhesive
(P/N - 2716)

* Optional Components for Splice Procedures. Place order for required Quantities

Components shown below vary in size and profile depending on model of system

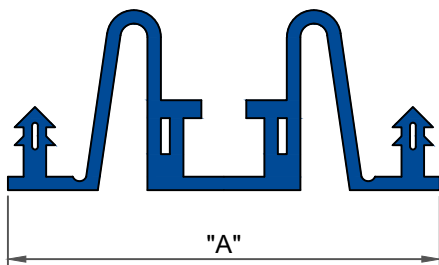

Elastomeric Visual Seal
(For Part Number Refer to Chart, Black seal)

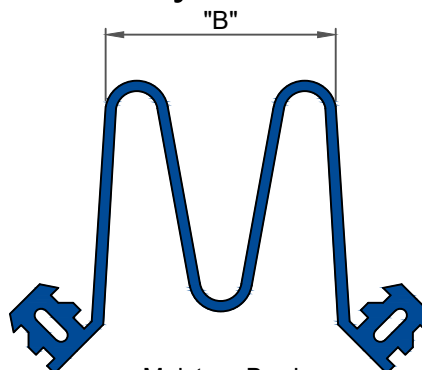

Moisture Barrier
(For Part Number Refer to Chart)

Dimension Chart & Part Number		
Model	"A"	Part Number
WSC-200	2"	1201
WSC-300	3"	1204
WSC-400	4"	1342
WSC-500	5"	1262
WSC-600	6"	1362

Dimension Chart & Part Number		
Model	"B"	Part Number
WSC-200	1 3/8"	1181
WSC-300	1 3/8"	1181
WSC-400	4 1/8"	1175
WSC-500	4 1/8"	1175
WSC-600	4 1/8"	1175

Flush Condition

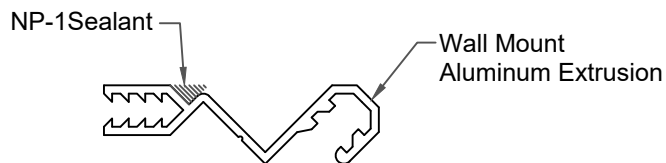

- 1** Apply continuous bead of NP-1 Sealant along back of the aluminum extrusions prior to installation. (exterior only)

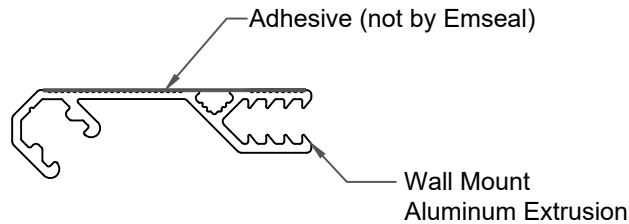

- 2** Apply adhesive along back of the aluminum extrusions prior to installation. (following adhesive manufacturers guidelines).
Note: Adhesive manufacturer may require coating adjacent surfaces, verify with adhesive manufacturer prior to proceeding.

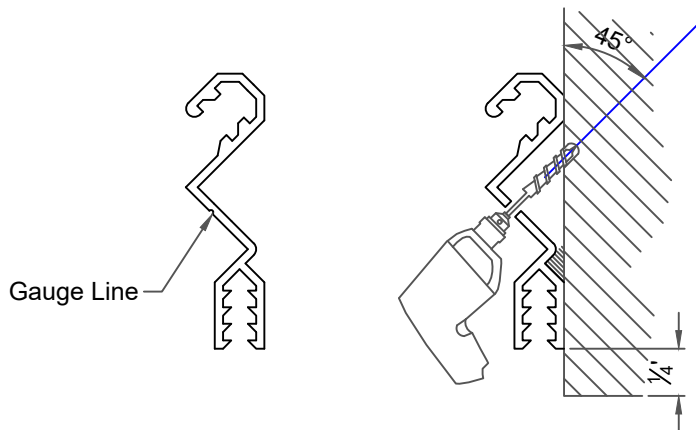

- 3** Field drill anchor holes at 18" O.C. (Max) along aluminum gauge line. Drill through aluminum into adjacent construction.
Note: All mortar joints in exterior walls must be flush with face of masonry to ensure tight weather seal.

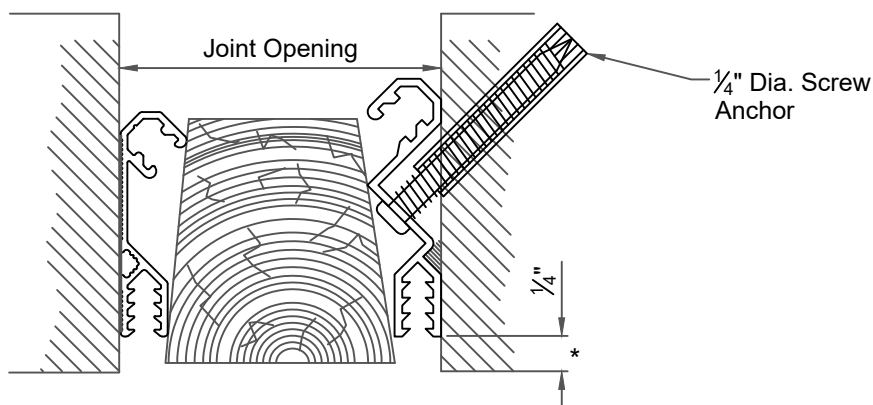

- 4** Field measure all lengths and directional changes for aluminum extrusions to ensure their proper layout where required. Mount extrusions to wall surface and install temporary wood blocking to secure extrusions to wall while adhesive cures. Contact adhesive manufacturer for proper cure times before proceeding to step 5.

* **Note:** Always review architectural plans for specific project requirements

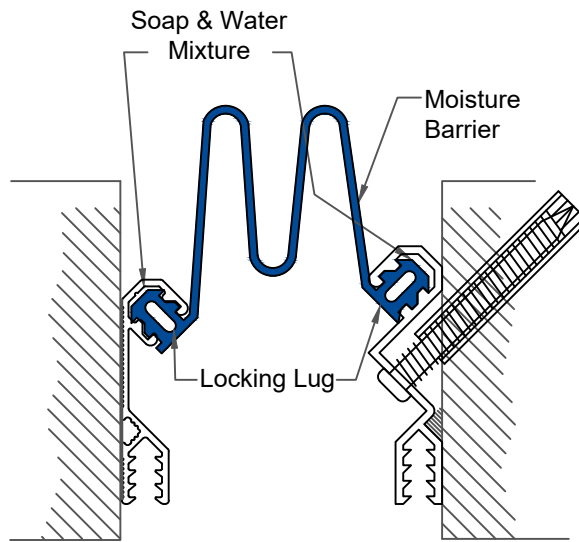

5

Before installing Moisture barrier spread a Soap & Water mixture into cavities of Aluminum extrusions. Ensure full engagement of locking lug.

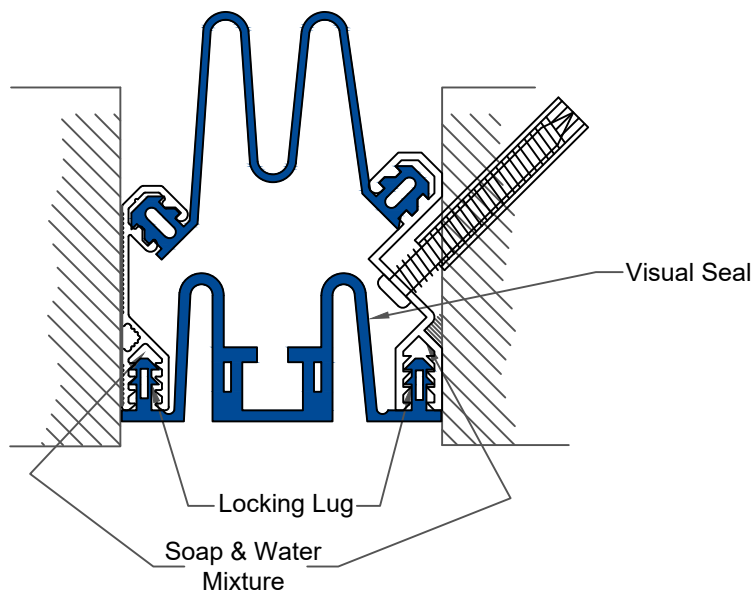

6

Before installing Visual Seal spread a Soap & Water Mixture into cavities of Aluminum extrusions. Ensure full engagement of locking lug.

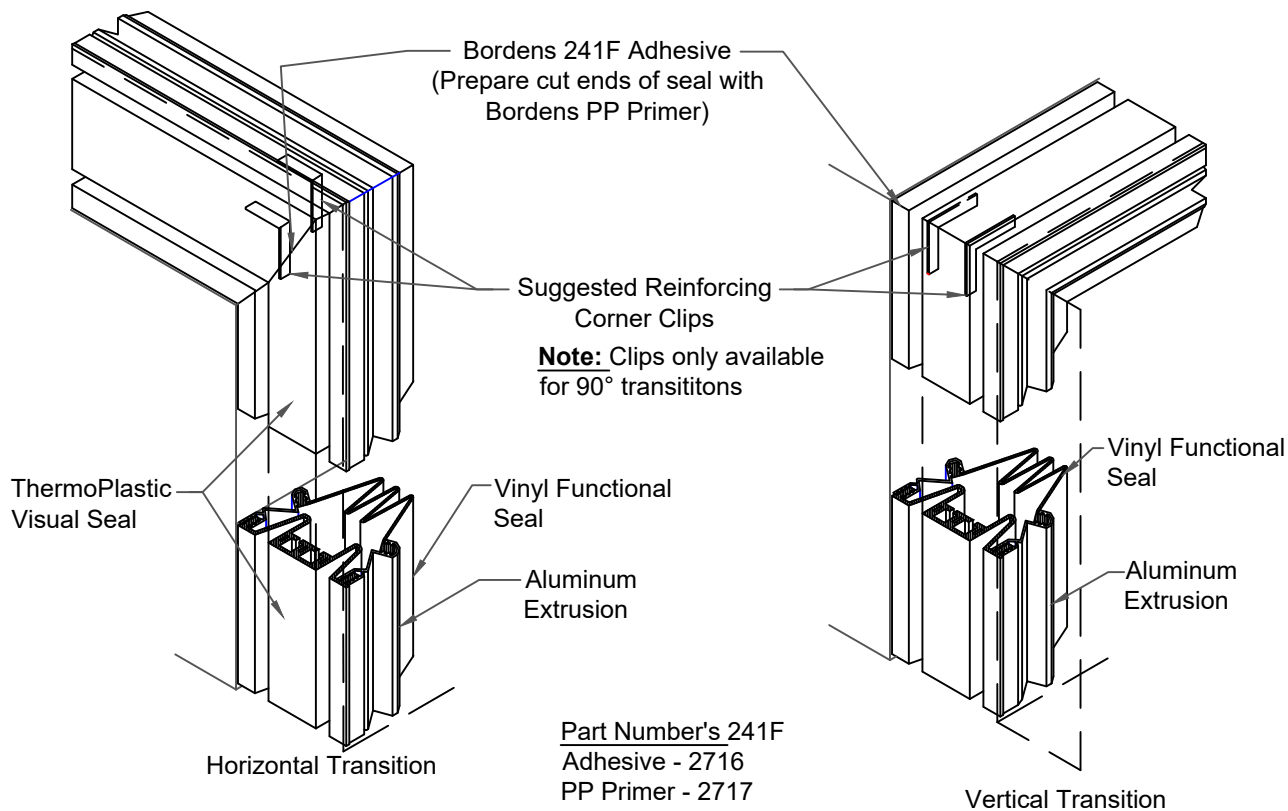

"WSW" Visual Seal Field Splice Procedures, "WSC" similar

Used for direction changes, Going around corners, Parapets, Etc
(TPV Only)

1. Cut ends of the WSW visual seal, with a sharp knife, to the desired angle using a formed jig with miter box (supplied by contractor). Insure cuts are clean, straight and square.
2. Cleans ends of seal with a solvent to remove any foreign material.
3. Brush apply PP Primer to both seal ends to be joined together at splice.
4. Reassemble mitered ends of adjacent seals utilizing the reinforcing corner clips (for 90° transitions only).
5. Apply Borden's 241F adhesive as specified by the manufacturer to one of the two seal surfaces to be bonded.
6. Apply pressure bringing the two surfaces in tight contact immediately upon completing application of the adhesive. Hold in place for approximately one to two minutes to allow adhesion.
7. Re-check quality of all miters or splices and apply additional adhesive if required to ensure proper miter or splice.
8. Contact manufacturer for clarification of above procedure (if required) prior to proceeding with splicing visual seal profile. It is usually recommended to allow 15 minutes time before installing spliced seal. Care shall be excersised as a result that it takes 24 hours for adhesive to fully cure.

Information provided herein, including but not limited to, any drawing, design, photograph, graphic, or statement(s) ("Materials") are proprietary and the property of Sika Emseal. ("Company"). Reproduction, translation, or reduction to any electronic medium or machine readable form, in whole or part, is strictly prohibited, except for the express purpose for which it has been furnished, without prior written consent of Company. All Materials contained herein are provided by Company for information purposes only. Company reserves the right to amend or withdraw any information contained in the Materials without notice. All technical or other advice by Company, whether verbal or written, concerning products, or the use of products in specific situations ("Advice") is given by Company and is used at the User's own risk.

Sika Emseal
25 Bridle Lane, Westborough, MA 01581 USA
Phone: 508-836-0280 / Fax 508-836-0281
www.emseal.com

Rev. 1.0 04-11-2024

