

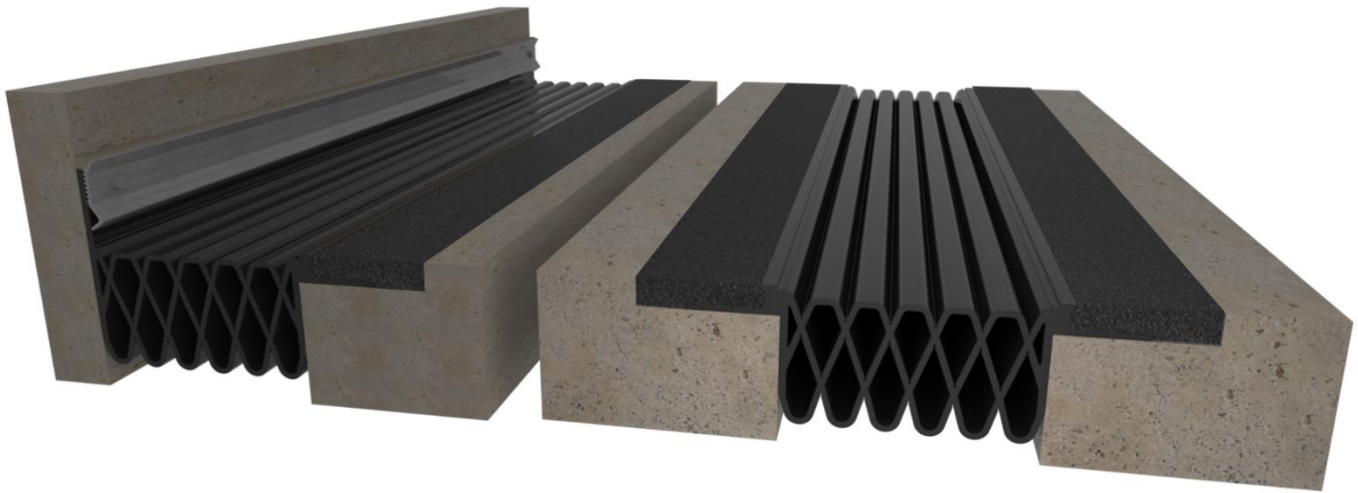

BUILDING TRUST



Installation Procedure



WaboCrete® Membrane Generation II (Black)

Membrane Sealing Expansion Joint System

The following installation procedure is very important and must be fully understood prior to beginning any work. To ensure proper installation and performance of expansion joint system the following actions must be completed by the installing contractor. **Failure to do so will affect product warranty.**

- 1) Carefully read and understand installation procedure. Contact Emseal's Technical Service Department at ((508) 836-0280 for product assistance.
- 2) Inspect all shipments and materials for missing or damaged components and hardware. Contact Customer Service at (508) 836-0280 with Emseal's order number and invoice for prompt assistance.
- 3) Inspect substrate or adjacent construction for acceptance before beginning work. Report unacceptable construction to the project manager for scheduled repair work.
- 4) Review Emseal shop drawings for project specific detailed information if Engineering services were purchased at time of order.



BUILDING TRUST



Health & Safety

During the installation of any Sika Emseal product, appropriate personal protective items should be worn at all times, including but not limited to the following:

- Proper work clothing
- Safety glasses
- Safety boots
- Gloves
- Hard hat



Local rules and regulations regarding safe work environments and health should be followed.

Product Components

Required Components



WaboCrete® Parking Series Elastomeric Concrete with Wabocrete II Part B Black:
Part A (P/N: 14380H), Part B (black) (P/N: 14381G), Part C (P/N: 33138)



Wabo®Bonding Agent,
Part A (P/N: 1931J), Part B (P/N: 1933J)

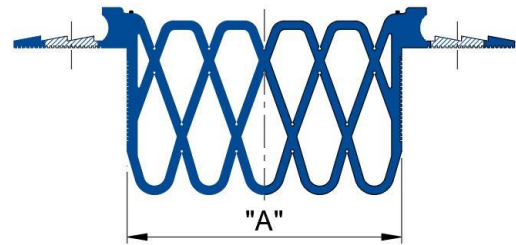

WaboCrete®Membrane Gen II “ME” Series Gland
(See Chart on Page 3 for Seal Sizes)

Component size and shape vary depending on seal



BUILDING TRUST



Sealing Gland Size Chart

Description	Installation Width				Seal Width (Relaxed)
	Min (in)	Min (mm)	Max (in)	Max (mm)	"A"
ME-250 (#8828X)	1.00	25	1.75	44	1 7/8"
ME-250C (#8828XC)	1.00	25	1.75	44	1 7/8"
ME-300 (#8825X)	1.00	25	2.25	57	2 1/4"
ME-300C (#8825XC)	1.00	25	2.25	57	2 1/4"
ME-450 (#8881X)	1.50	38	3.00	76	3"
ME-450C (#8881XC)	1.50	38	3.00	76	3"
ME-600 (#8883X)	2.00	51	4.00	102	4 3/16"
ME-600C (#8883XC)	2.00	51	4.00	102	4 3/16"
ME-700 (#8885X)	2.50	64	5.00	127	5 3/16"
ME-700C (#8885XC)	2.50	64	5.00	127	5 3/16"
ME-850 (#8887X)	3.00	76	6.00	152	6 3/16"
ME-850C (#8887XC)	3.00	76	6.00	152	6 3/16"

Optional Components



WaboCrete® Elastomeric Concrete Non-Flow Additive
 (for sloped, crowned or ramped surfaces) P/N: 14389
Add maximum one bag to one unit of Elastomeric Concrete (see p11)



NEW Sikadur 229 66lb Bag (30.0 KG)
 (P/N: 33137) for broadcasting onto WaboCrete®
 Parking Series Elastomeric Concrete exposed surface.



BUILDING TRUST



Pre-Installation Notes

Concrete Substrate must be clean (free of dirt, dust, coatings, rust, grease, oil and other contaminants), sound and durable. New concrete must be fully cured (Min. 14 days) and all laitance removed.

Mask joint edges with duct tape & roofing paper to ensure a clean final appearance.

Clean blockout with dry compressed air. (see Installation Step #1 on next page).

(space intentionally left blank)



BUILDING TRUST



Installation

1 Blockouts must be formed to 3 1/2" (89) wide and 3/4" (19) in depth. Abrasive blast the concrete breakout surfaces to remove the foam release agents, grease, bond breakers and to enhance bonding surface. **Note:** Abrasive blasting is the preferred method. Grinding with an aggressive concrete disc is acceptable when abrasive blasting is not possible (i.e. using zec wheel or diamond cup wheel).

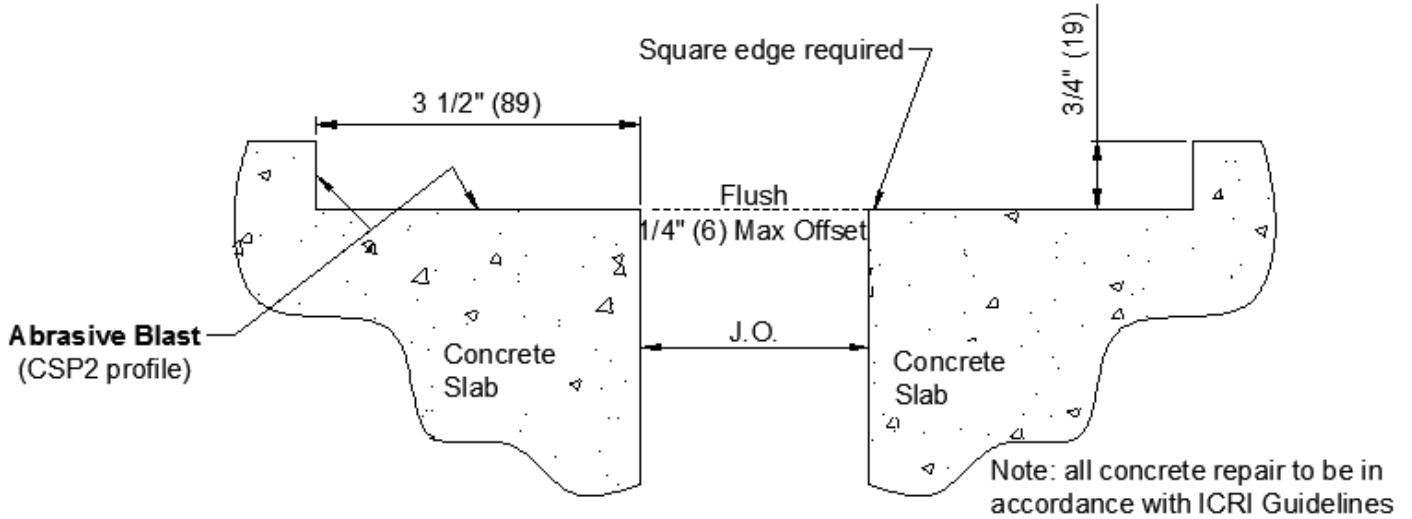

2 Position seal over the joint opening as shown (Fig. 1). Compress bottom portion of seal and insert into joint as shown (Fig. 2). Complete installation by positioning seal within the joint to a depth so that the seal flaps lay flat in blockout. It may be necessary to make relief cuts in seal flaps in order for them to lay flat. Relief cuts should be made in a triangular shape. Do not remove large portions of seal flaps. Remove only enough to encourage seal to flatten – as shown below.

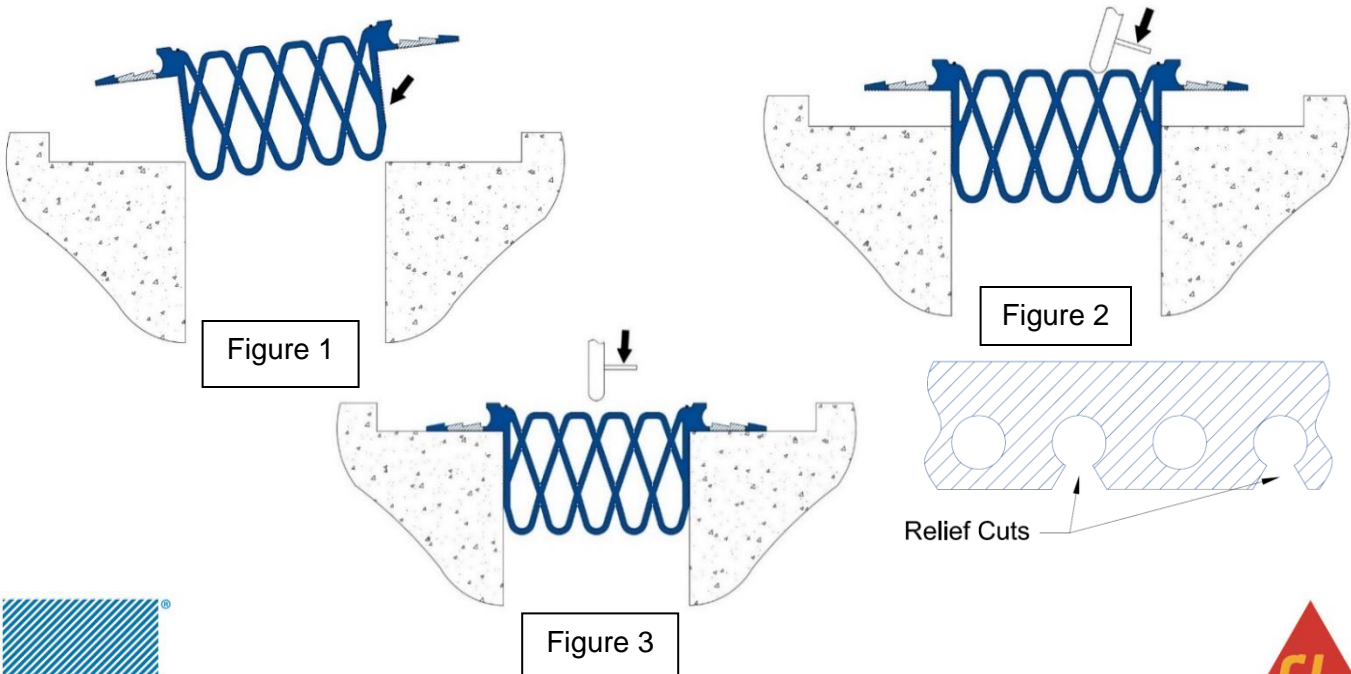

- 3** Tape the top of the seal with duct tape in area shown above. The edges of the blockouts should be covered with roofing paper taped down with duct tape to keep area clean during pouring of WaboCrete® Parking Series Elastomeric Concrete.

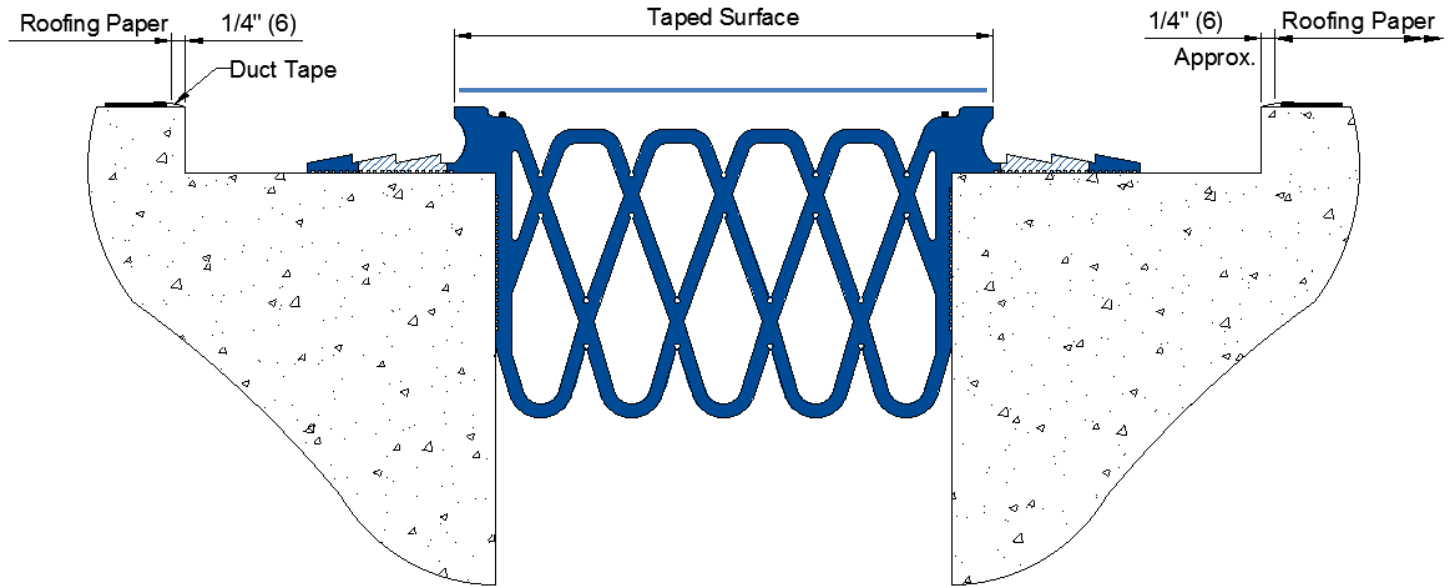

(space intentionally left blank)



4

Wabo® Bonding agent must be used as a primer on the properly prepared dry concrete before beginning the installation of WaboCrete® Parking Series Elastomeric Concrete. **Wabo® Bonding agent is meant for the concrete, it is not required on the seal.** Lift flaps of the seal as shown below and brush apply a thin layer of Bonding agent to the concrete surface and lay flap back down. When Bonding agent is installed, the concrete shall look wet, ensure that ponding or puddles are not occurring. **DO NOT** allow the bonding agent to cure (you must pour wet-on-wet). Immediately following application of bonding agent, begin installation of WaboCrete® Parking Series Elastomeric Concrete.

WaboCrete® Parking Series Note: **DO NOT** mix partial units of WaboCrete® Parking Series Elastomeric Concrete. Thoroughly stir WaboCrete II Part B (black), scraping the can before pouring entire contents of Part B into a clean 5 gallon plastic bucket.

Add Part A and mix both components with a 3/4" Low RPM drill equipped with large grout paddle for 30 seconds and until well blended.

Add aggregate component to the liquid material and mix until all aggregate is coated (Approx. 1.5 minutes). Pour WaboCrete® Parking Series Elastomeric Concrete mix flush to the top of the seal bulkhead and adjacent existing surface. The material will flow and self-level.

Lightly trowel surface to a smooth finish. If desired, solvent (i.e. Xylene, Toluene) can be used while troweling and for cleanup of tools.

Optional: After 2-3 minutes, broadcast Sikadur®-229 Aggregate to refusal (medium grit). This enhances WaboCrete® Parking Series Elastomeric Concrete aesthetic, UV stability and skid-resistance.

Remove tape from top of seal immediately after installation of WaboCrete® Parking Series Elastomeric Concrete is completed.

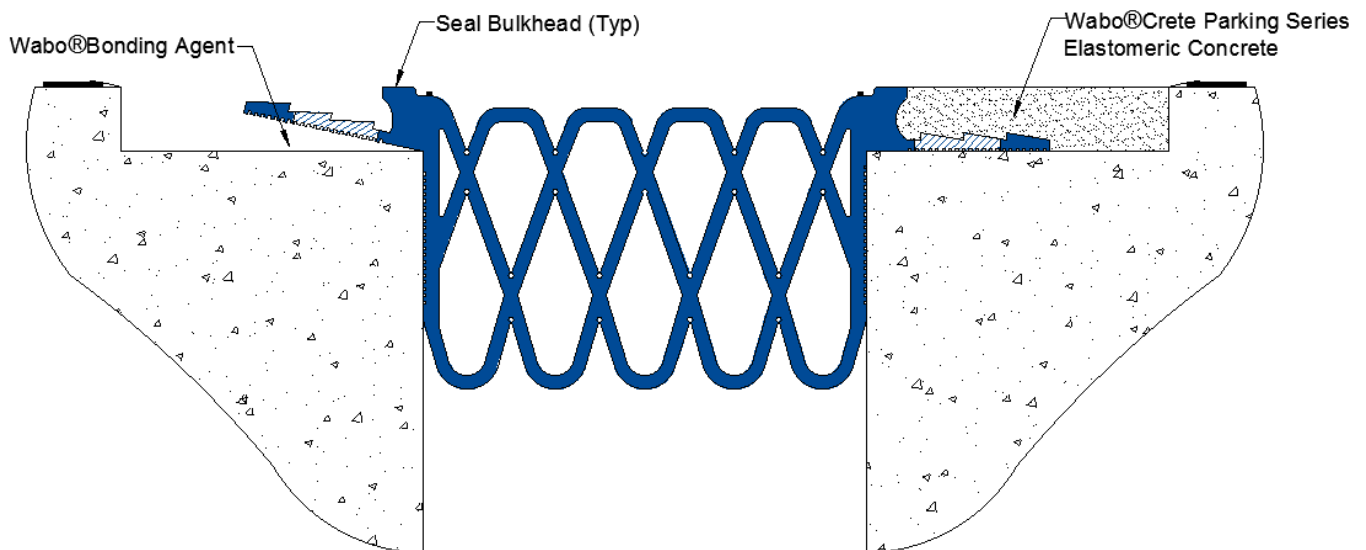

BUILDING TRUST



Deck-to-Wall Applications

5 Using standard Retainer/Bracket.

After installation of WaboCrete® Parking Series Elastomeric Concrete (in horizontal), place seal flap up along vertical surface as shown below.

After seal flap is in place, place aluminum wall mount plate against vertical flap as shown below. Fasten wall mount plate to structure utilizing the 1/4" Dia. x 2 1/4" lg Stainless Steel Tapcon Anchors (P/N 6542) supplied.

When installing anchors make sure that the Aluminum Retainer is mounted against the elastomeric seal (see below). This is to ensure that there will be good compression of the seal against the wall. To help ensure a watertight installation apply a continuous bead of sealant along top edge of the wall mount plate as shown below.

Note: Manufacturer recommends minimum two anchors at a column installation.

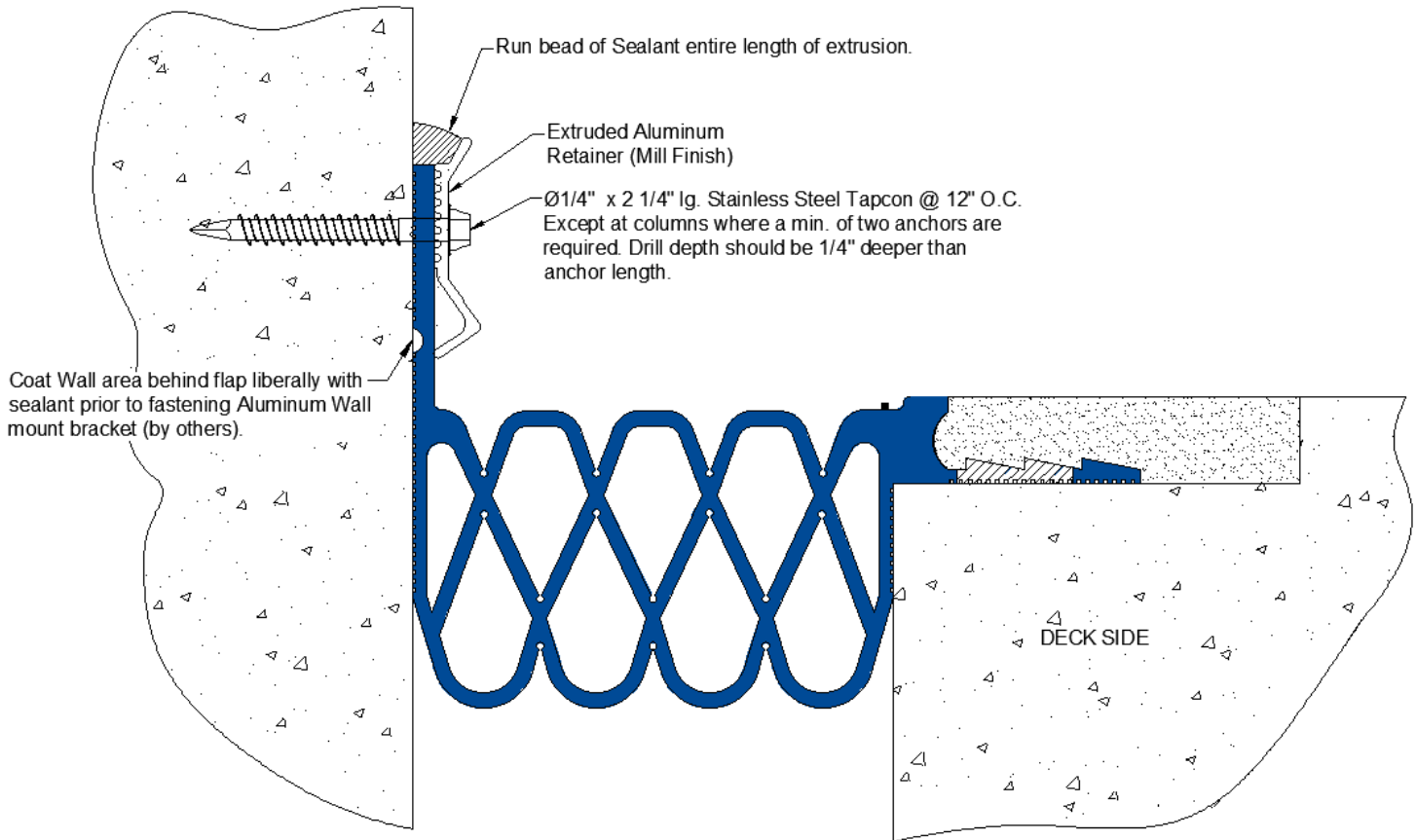

6A Optional: Apply Sikadur-229 - Horizontal Only
application

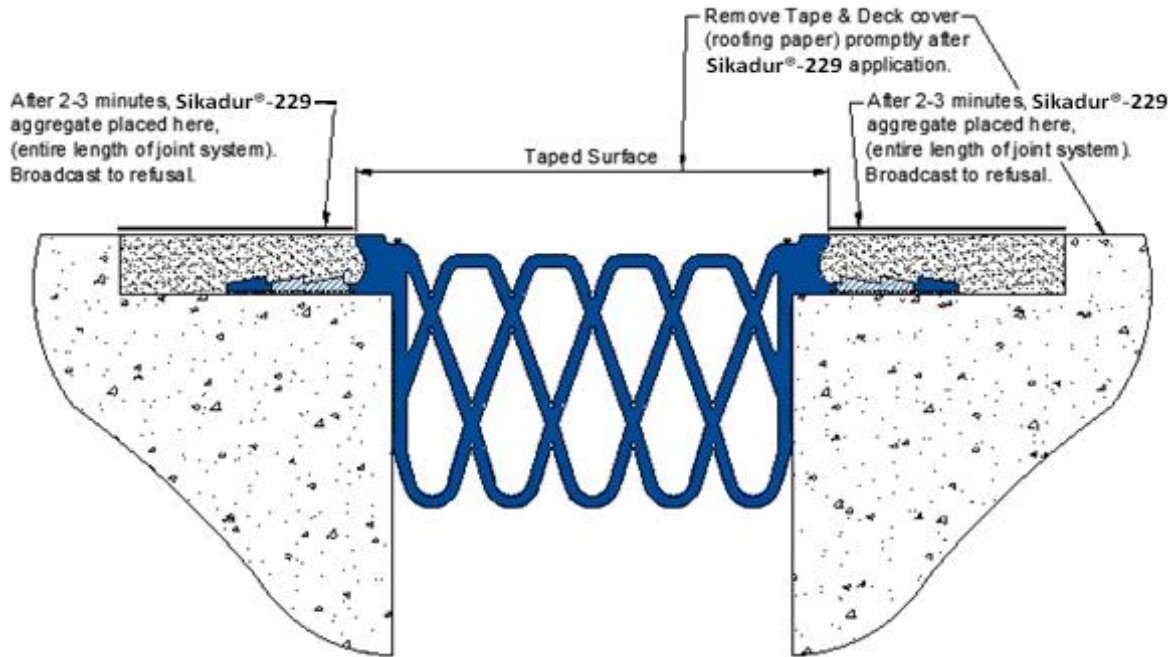

6B

Optional: Apply Sikadur-229 Deck-to-Wall Application

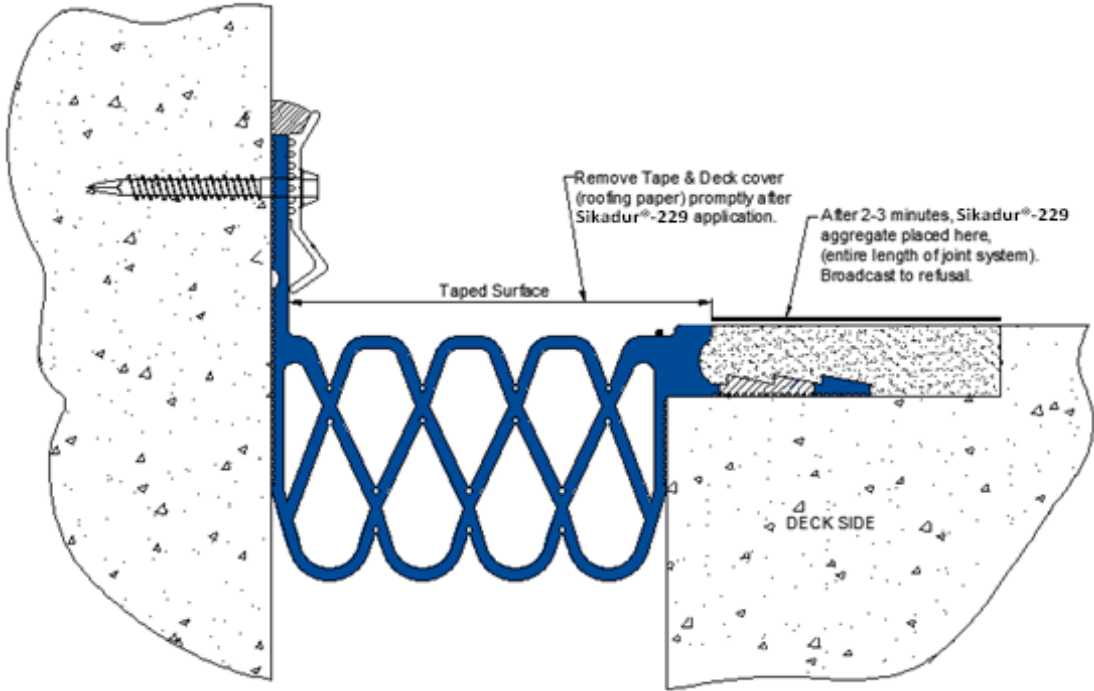

Recommended Equipment for Mixing of Elastomeric Concrete

- Abrasive blasting Equipment
- 3/4" Heavy Duty Drill (1 hsp - Low RPM)
- 3/8" Hand Drill
- (1) Large Grout Paddle (4" to 6")
- (1) Small Paddle (2")
- (1) Roll of 15lb Roofing Paper
- (2) Clean 5 gallon plastic buckets
- (4) Clean 1 gallon plastic buckets (For bonding agent)
- (8) 2" disposable paint brushes (For Bonding agent)
- Rubber gloves
- (8) 2" Margin trowels
- Misc. hand tools and extension cords

Yield Calculations for WaboCrete Parking Series:

Series:

- One unit of WaboCrete® Parking Series will yield .60 ft³.
- One unit of WaboCrete® Parking Series = One US half gallon Part A, One gallon Part B, and one 60 lb Container of aggregate. the formula for calculating volume is: (length in feet x width in inches x depth in inches)/ 86.4 = Number of units of WaboCrete® Parking Series needed to complete the job.

Example

Based on a blackout size 3 1/2" wide x 3/4" deep x 30' long:

The calculation would be: (.0304 x 30)= .91 units. This calculation is for only ONE side of the bockout.

Curing of WaboCrete®:

WaboCrete® Parking Series is an ambient cure material. Cure times are therefore, temperature dependant.

Suggested cure times are listed below:

Cure Time: 21° - 32°C (70°-90°F) -1 to 1 1/2 Hours
(Open to Traffic) 10° - 21°C (50°-70°F) - 1 1/2 to 2 Hours
4° - 10°C (40°-50°F) - 2 to 3 Hour

Sloped/Vertical Conditions (using Non-Flow Additive):

1. Premix Part B for 20 seconds (Scraping sides and bottom of can)
2. Pour Part B into clean empty 5 gallon bucket
3. Add Non-Flow additive, blend for 30 seconds
4. Pour into Part A
5. Add Part C and mix for 1.5 minutes
6. Pour into blockout and work WaboCrete Parking Series with trowel into sloped condition until it sets up and stays in sloped position.

Notes:

All yields are approximate and do not include allowance for uneven blockouts, waste etc.



BUILDING TRUST



Information provided herein, including but not limited to, any drawing, design, photograph, graphic, or statement(s) ("Materials") are proprietary and the property of Sika Emseal. ("Company"). Reproduction, translation, or reduction to any electronic medium or machine readable form, in whole or part, is strictly prohibited, except for the express purpose for which it has been furnished, without prior written consent of Company. All Materials contained herein are provided by Company for information purposes only. Company reserves the right to amend or withdraw any information contained in the Materials without notice. All technical or other advice by Company, whether verbal or written, concerning products, or the use of products in specific situations ("Advice") is given by Company and is used at the User's own risk.

Sika Emseal
25 Bridle Lane, Westborough, MA 01581 USA
Phone: 508-836-0280 / Fax 508-836-0281
www.emseal.com

Rev. 1.2 05-31-2024



BUILDING TRUST

